



WHEEL DRIVE END

NUT

LENGTH: \_\_\_\_\_

THREAD PITCH: \_\_\_\_\_

DRIVE THREAD DIAMETER: \_\_\_\_\_

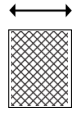

SPEEDO CLOCK END

NUT

LENGTH: \_\_\_\_\_

THREAD PITCH: \_\_\_\_\_

CLOCK THREAD DIAMETER: \_\_\_\_\_



HEX NUT

LENGTH: \_\_\_\_\_

THREAD PITCH: \_\_\_\_\_

DRIVE THREAD DIAMETER: \_\_\_\_\_

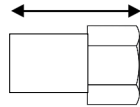

HEX NUT

LENGTH: \_\_\_\_\_

THREAD PITCH: \_\_\_\_\_

CLOCK THREAD DIAMETER: \_\_\_\_\_

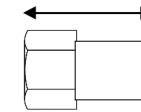

SPEEDO / TACHO CABLE DIMENSIONS

PLEASE TICK THE OPTION BOXES AND INPUT DIMENSIONS

LENGTH FROM END OF FERRULE TO END OF FERRULE:

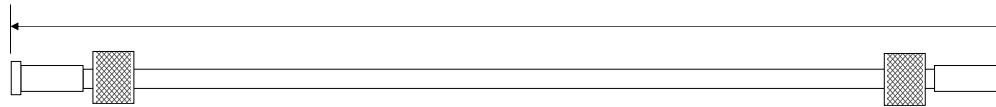

INNER WIRE PROTRUSION FROM FACE OF FERRULE (DRIVE END): \_\_\_\_\_

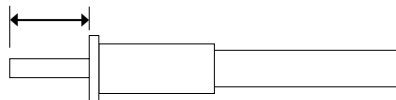

INNER WIRE PROTRUSION FROM FACE OF FERRULE (CLOCK END): \_\_\_\_\_

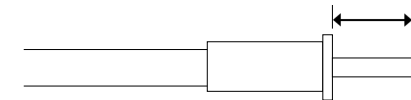

INNER WIRE DIAMETER:

2.9mm

3.6mm

TYPE OF FITTING GOING INTO THE DRIVE

SQUARED INNER WIRE

SPADE END FITTING

FORK END FITTING

ARMOUR SPRING?

YES

NO

TYPE OF FITTING GOING INTO THE CLOCK

SQUARED INNER WIRE

SPADE END FITTING

FORK END FITTING